

ENGINE FOR GK8357CI

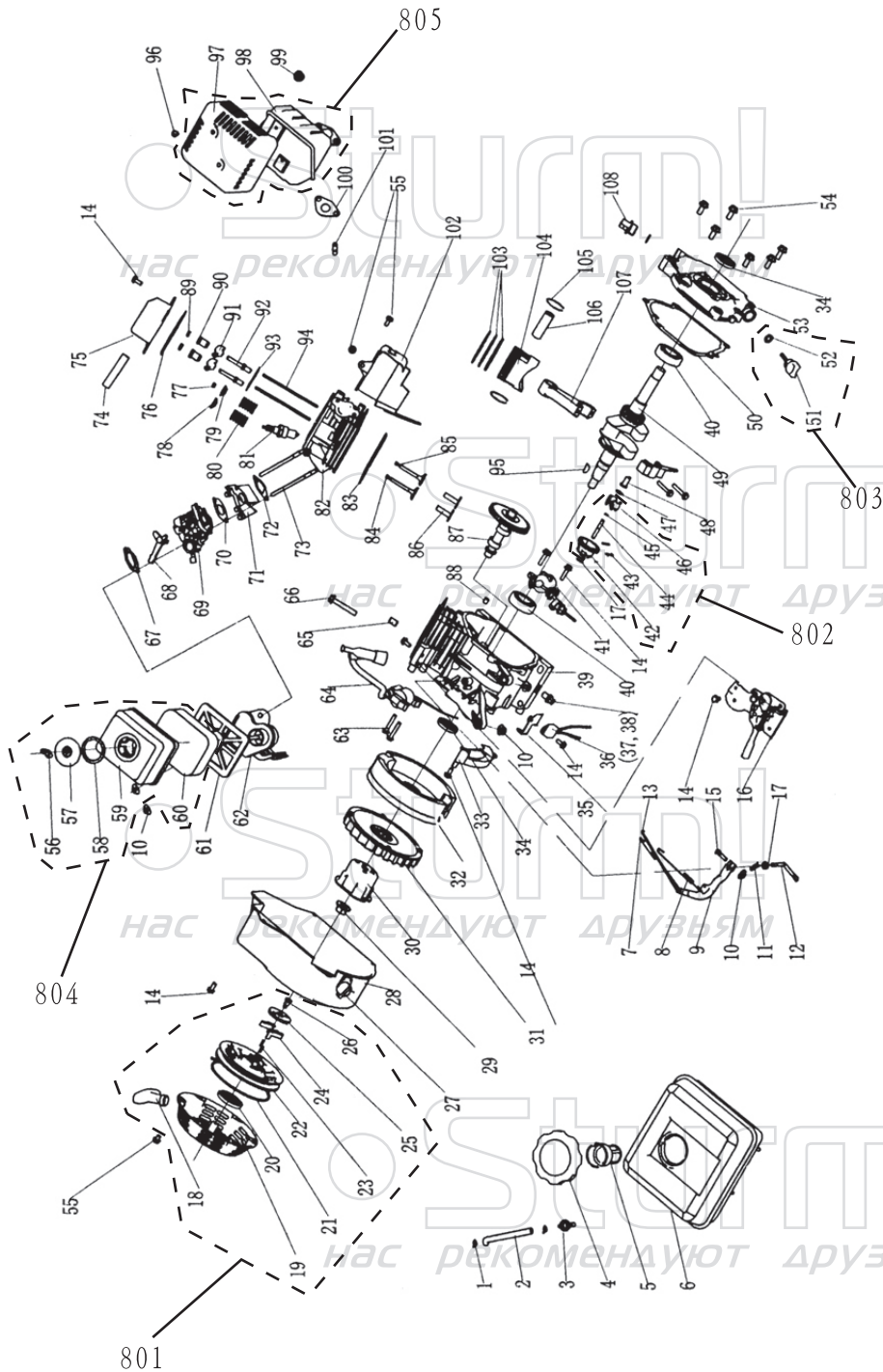

NO.	DESCRIPTION	NO.	DESCRIPTION	NO.	DESCRIPTION
1	CLIP TUBE	39	CRANK CASE	77	RATATOR VALVE
2	TUBE FUEL	40	BEARING RADIAL BALL	78	SEAL GUIDE
3	JOINT ASSY FUEL TANK	41	OIL LEVEL SWITCH	79	RETAINER VALVE SPRING
4	CAP COMP FUEL FILLER	42	GEAR GOVERNOR	80	SPRING VALVE
5	FILTER FUEL	43	PIN GOVERNOR WEIGHT	81	PLUG SPARK
6	OIL TANK	44	SHAFT GOVERNOR	82	HEAD COMP CYLINDER
7	OIL LINE	45	CLIP GOVERNOR HOLDER	83	GASKET CYLINDER
8	SPRING THROTTLE RETURN	46	WEIGHT GOVERNOR	84	VALVE IN
9	ARM GOVERNOR	47	WASHER PAIN 6×15×0.5	85	VALVE EX
10	NUT FLANGE	48	SLIDER GOVERNOR	86	LEFTER VALVE
11	PIN LOCK	49	CRANKSHAFT COMP	87	CAMSHAFT ASSY
12	SHAFT GOVERNOR ARM	50	PACKING CASE COVER	88	PIN FLYING BLOCK
13	ROD GOVERNOR	51	OIL FILLER CAP	89	NUT PIVOT ADJUSTING
14	BOLT FLANGE	52	PACKING OIL FILLER CAP	90	PIVOT ROCKER ARM
15	BOLT QUADRATE HEAD	53	COVER	91	ARM VALVE ROCKER
16	CONTROL ASSY	54	BOLT FLANGE	92	BOLT PIVOT ARM
17	WASHER PAIN	55	BOLT FLANGE	93	PLATE ASSY
18	KNOB RECOIL STARTER	56	NUT TOOL BOX SETTING	94	ROD PUSH
19	COVER COMP FAN	57	COVER AIR CLEANER	95	KEY SPECIAL WOODRUFF
20	SPRING RECOIL SATRTER	58	SEAL AIR CLEANER	96	SCREW TAPPINIG 5*8
21	REEL RECOIL STARTER	59	COVER AIR CLEANER	97	PROTECTOR MUFFLER
22	ROPE	60	FILTER OUTER	98	MUFFLER ASSY
23	SPRING RETURN	61	AIR CLEANER PLATE	99	NUT HEX 8MM
24	RATCHET STARTER	62	ELBOW COMP AIR CLEANER	100	GASKET MUFFLER
25	GUIDE RATCHET	63	BOLT FLANGE 6*25	101	BOLT STUD EXHAUST
26	SCREW SETTING	64	COIL ASSY IGNITION	102	SHROUD
27	SWITCH ASSY ENGINE STOP(OIL ALERT)	65	PIN DOWER	103	RING SET
28	COVER COMP FAN	66	BOLT FLANGE 8*55	104	PISTON
29	NUT SPECIAL	67	SPACER COMP AIR CLEANER	105	CLIP PISTON PIN
30	PULLEY STARTER	68	LEVER COMP CHOKE	106	PIN PISTON
31	FAN COOLING	69	CARBURETOR	107	CONNECTING ROD
32	FLYWHEEL COMP	70	PACKING CABURETOR	108	OIL STICK
33	DIVERSION ASSY	71	INSULATOR CARBURETOR	801	RECOIL STARTER
34	OIL SEAL 25*41.25*6	72	PACKING INSUL ATOR	802	GEAR GOVERNOR ASSEMBLY
35	PLATE SIDE SUPPORT	73	BOLT STUD IN	803	OIL FILLER CAP ASSEMBLY
36	ALART UNIT OIL	74	TUBE BREATHER	804	ARI FILTER
37	BOLT DRAIN PLUG	75	COVER COMP HEAD	805	MUFFLER
38	WASHER DRAIN PLUG 10×15×1.2	76	PACKING HEAD COVER		

RU-ST20181107

GK8357CI

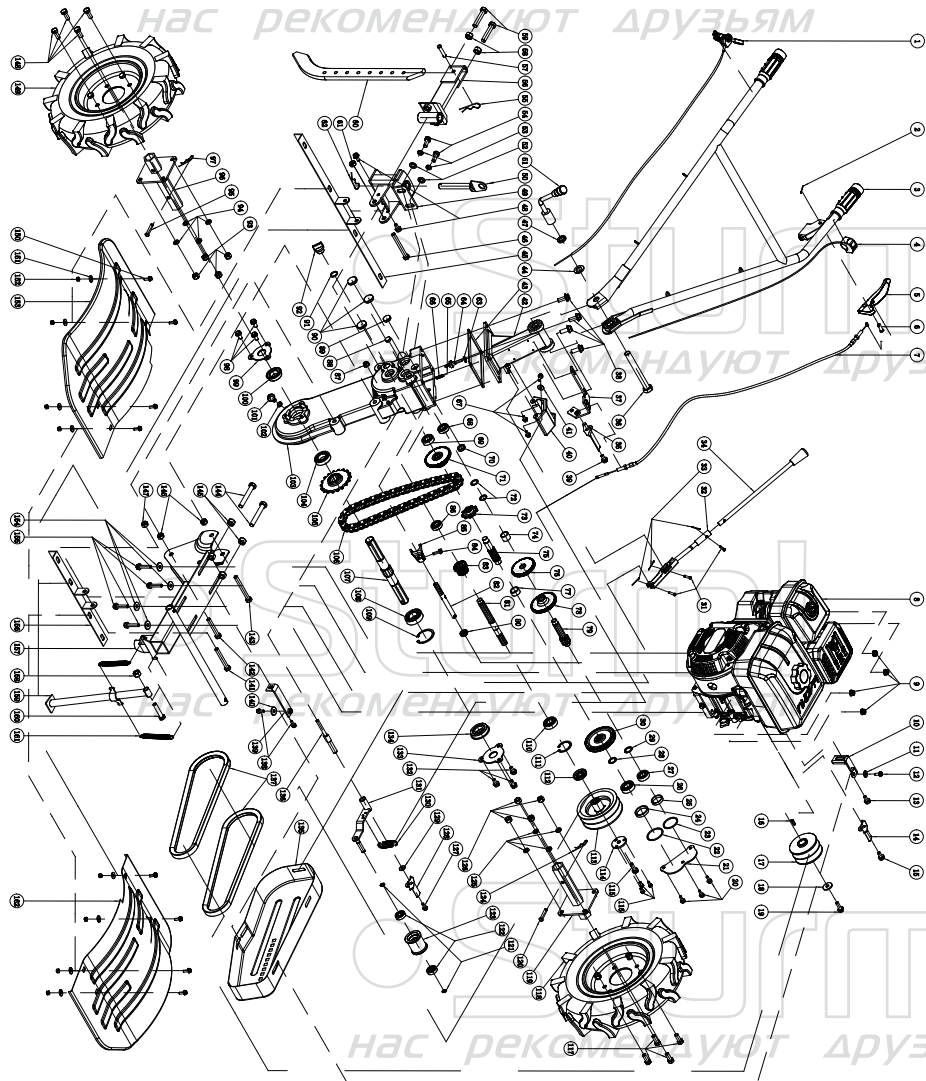

NO.	DESCRIPTION	NO.	DESCRIPTION	NO.	DESCRIPTION	NO.	DESCRIPTION
1	Throttle switch	48	FLANGE BOLT M8*16	95	Pin $\Phi 8*40$	142	Hexagon bolt M10*65
2	Clip $\Phi 1.6*25$	49	Trailer body assembly	96	Axle	143	Hexagon bolt M10*90
3	Handle frame	50	Big pin	97	B type pin $\Phi 8*\Phi 2*38$	144	Hexagon bolt M12*80
4	Extinction switch	51	Locking handle	98	FLANGE BOLT M8*16	145	Hexagon nut M12
5	Clutch handle	52	plain washer $\Phi 10$	99	Dust proof cover, left	146	Hexagon lock nut M10
6	PIN $\Phi 8*24$	53	Spring washer $\Phi 10$	100	Steel oil seal	147	FLANGE BOLT M8
7	Clutch cable	54	Hex bolt M10*25	101	Oil drian plug bolt M10*1.25*15	148	FLANGE BOLT M10*25
8	Gasoline engine	55	B type pin $\Phi 8*\Phi 2*38$	102	Aluminum washer $\Phi 10*\Phi 15*1$	149	Wheel assy.
9	Adjustive nut M8	56	Connector assembly	103	Gear box	150	Bolt M6*16
10	Belt adjustment block A	57	Pin $\Phi 8*40$	104	Deep groove ball bearing	151	Plain washer
11	Plain washer $\Phi 6$	58	Hex nut M12	105	Driven sprocket	152	FLANGE NUT M6
12	Bolt M6*14	59	Hex bolt M12*60	106	Chain,	153	Fender, left
13	Bolt M8*16	60	Resistance bar	107	hexangonal output shaft	154	Big plain washer
14	Belt adjustment C	61	Hexagon lock nut M10	108	Deep groove ball bearing	155	FLANGE BOLT M8*40
15	Bolt M8*16	62	B type pin $\Phi 8*\Phi 3*60$	109	Steel ring washer	156	Fender front support
16	Key 6*6*20	63	Oil seal rubber gasket	110	Deep groove ball bearing	157	Engine support
17	Driving pulley	64	oil level indicator	111	Steel ring washer	158	Hexagon lock nut M10
18	Plain washer $\Phi 8$	65	Steel ball	112	Oil seal	159	Engine support(front support)
19	Flange bolt M8*25	66	Gear shifting spring	113	Driven pulley	160	Hexagon bolt M10*50
20	Bolt M6*12	67	Hexangular flange bolt M6*12	114	Driven pulley cover	161	Engine support(front spring)
21	B type cover	68	Deep grove ball bearing	115	FLANGE BOLT M8*25	162	Fender, right
22	O ring $\Phi 45*2.65$	69	Deep grove ball bearing	116	FLANGE NUT M6*16		
23	O ring $\Phi 40*2.65$	70	Plug seal $\Phi 22*6$	117	Hexagon bolt M10*25		
24	Backstop washer $\Phi 40*\Phi 34*7$	71	Reverse gear duplicate gear	118	Wheel assy.		
25	Backstop washer $\Phi 34*\Phi 30*7$	72	Falt washer $\Phi 22*\Phi 16*0.8$	119	Axle		
26	Deep groove ball bearing	73	Main drive sproket	120	Pin $\Phi 8*40$		
27	Deep groove ball bearing	74	Main shaft sleeve, $\Phi 23*\Phi 18.5*17$	121	Tensioning wheel steel washer		
28	Adjustment gasket $\Phi 24*\Phi 17*1$	75	Main drive sproket shaft	122	Deep groove ball bearing		
29	Adjustment gasket $\Phi 30*\Phi 17.5*2$	76	Fast gear	123	Tensioning wheel		
30	driving gear	77	Main shaft sleeve $\Phi 25.5*\Phi 20*12$	124	B type pin $\Phi 8*\Phi 2*38$		
31	PIN $\Phi 5*26$	78	Slow gear	125	Spring washer		
32	Gear shifting rod	79	Second shaft	126	Hexagon lock nut M10		
33	clip $\Phi 1.6*25$	80	Oil seal $\Phi 12*\Phi 22*6$	127	FLANGE BOLT M8*16		
34	Gear shifting control rod	81	Main shaft	128	Belt adujust block		
35	belt adjustment C	82	Shifting fork shaft	129	Plain washer		
36	bolt M16*150	83	Main shaft duplicate gear	130	Tensioning wheel spring		
37	tensioning cable support	84	FLANGE BOLT M6*16	131	Tensioning wheel connecting rod		
38	FLANGE BOLT M8*25	85	Shifting fork	132	FLANGE BOLT M8*16		
39	FLANGE BOLT M8*16	86	Deep grove ball bearing	133	hexangonal output shaft cover, right		
40	gear showing cover	87	Self-locking nut M8	134	Steel oil seal		
41	plain washer $\Phi 6$	88	Plug seal $\Phi 16*6$	135	Belt cover		
42	handle stand	89	Plug seal $\Phi 22*6$	136	Tensioning wheel shaft		
43	Gear box packing	90	Plug seal $\Phi 28*6$	137	belt		
44	plain washer $\Phi 16$	91	O type seal ring	138	FLANGE BOLT M8*16		
45	fender rear support	92	oil level indicator	139	Belt cover support		
46	Hexangular flange bolt M10*90	93	Hexagon lock nut M10	140	Big plain washer		
47	Spring washer $\Phi 16$	94	Spring washer	141	FLANGE BOLT M8*65		